

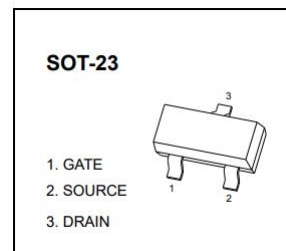

AD-CJ2310 Plastic-Encapsulated MOSFET

AD-CJ2310 N-Channel MOSFET

$V_{(BR)DSS}$	$R_{DS(on), max}$	I_D
60V	105mΩ @ 10V	3A
	125mΩ @ 4.5V	



DESCRIPTION

The AD-CJ2310 uses advanced trench technology to provide excellent $R_{DS(ON)}$, low gate charge and operation with gate voltage as low as 2.5V. This device is suitable for use as a battery protection or in other switching application.

FEATURES

- High power and current handling capability
- Lead free product is acquired
- Surface mount package
- AEC-Q101 qualified

APPLICATIONS

- Battery Switch
- DC/DC converter

MARKING

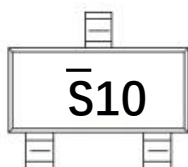

S10= Device code

EQUIVALENT CIRCUIT

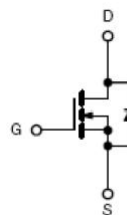

MAXIMUM RATINGS ($T_j = 25^\circ\text{C}$ unless otherwise specified)

Parameter	Symbol	Value	Unit
Drain-source voltage	V_{DS}	60	V
Gate-source voltage	V_{GS}	± 20	V
Continuous drain current	I_D	3	A
Pulsed Drain Current	$I_{DM}^{1)}$	10	A
Power dissipation($T_c = 25^\circ\text{C}$)	P_D	2.5	W
Thermal resistance from junction to case	$R_{\theta JC}$	50	$^\circ\text{C/W}$
Power dissipation ($T_a = 25^\circ\text{C}$)	$P_D^{2)}$	1	W
Thermal resistance from junction to ambient	$R_{\theta JA}^{2)}$	125	$^\circ\text{C/W}$
Operating junction and storage temperature range	T_j, T_{stg}	-55 ~ 150	$^\circ\text{C}$

ELECTRICAL CHARACTERISTICS ($T_j = 25^\circ\text{C}$ unless otherwise specified)

Parameter	Symbol	Test condition	Min	Typ	Max	Unit
Static characteristics						
Drain-source breakdown voltage	$V_{(BR)DSS}$	$V_{GS} = 0V, I_D = 250\mu A$	60	-	-	V
Zero gate voltage drain current	I_{DSS}	$V_{DS} = 60V, V_{GS} = 0V$	-	-	1.0	μA
Gate-body leakage current	I_{GSS}	$V_{GS} = \pm 20V, V_{DS} = 0V$	-	-	± 100	nA
Gate threshold voltage	$V_{GS(th)}$	$V_{DS} = V_{GS}, I_D = 250\mu A$	0.5	-	2	V
Forward transconductance	$g_{fs}^{(3)}$	$V_{DS} = 15V, I_D = 2A$	1.4	-	-	S
Diode forward voltage	$V_{SD}^{(3)}$	$I_S = 3A, V_{GS} = 0V$	-	-	1.2	V
Drain-source on-state resistance	$R_{DS(on)}^{(3)}$	$V_{GS} = 10V, I_D = 3A$	-	82	105	m Ω
		$V_{GS} = 4.5V, I_D = 2A$	-	91	125	
Dynamic characteristics ⁴⁾						
Total gate charge	Q_g	$V_{DS} = 30V, V_{GS} = 4.5V, I_D = 3A$	-	6	-	nC
Gate-source charge	Q_{gs}		-	1	-	
Gate-drain charge	Q_{gd}		-	1.3	-	
Input capacitance	C_{iss}	$V_{DS} = 30V, V_{GS} = 0V, f = 1MHz$	-	247	-	pF
Output capacitance	C_{oss}		-	34	-	
Reverse transfer capacitance	C_{rss}		-	19.5	-	
Switching parameters ⁴⁾						
Turn-on delay time	$t_{d(on)}$	$V_{DD} = 30V, I_D = 1.5A, V_{GS} = 10V, R_{GEN} = 1\Omega$	-	6	-	ns
Turn-off delay time	$t_{d(off)}$		-	15	-	
Rise time	t_r		-	15	-	
Fall time	t_f		-	10	-	

1) Repetitive rating : Pulse width limited by junction temperature

2) Measured with the device mounted on 1 inch² FR-4 board with 2oz. copper, in a still air environment with $T_a = 25^\circ\text{C}$.3) Pulse test: Pulse width $\leq 300\mu s$, duty cycle $\leq 2\%$.

4) Guaranteed by design, not subject to production.

TYPICAL CHARACTERISTICS

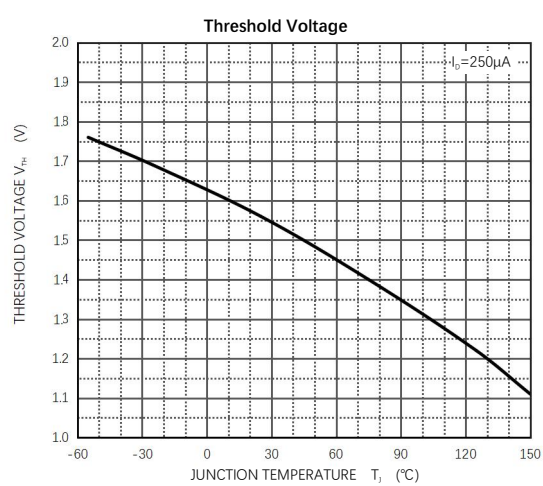
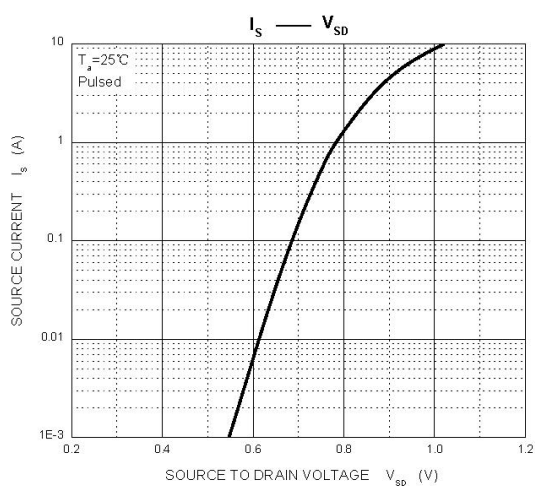
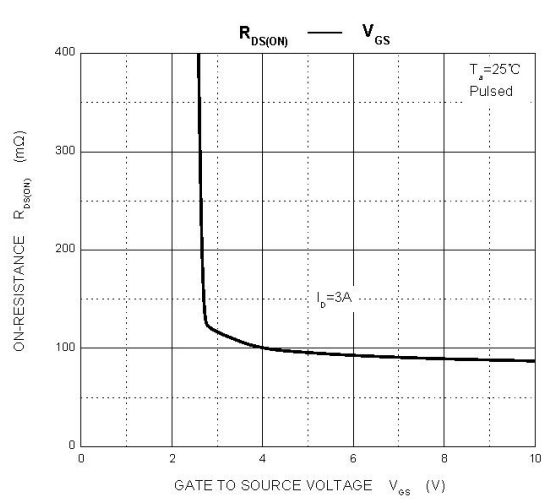
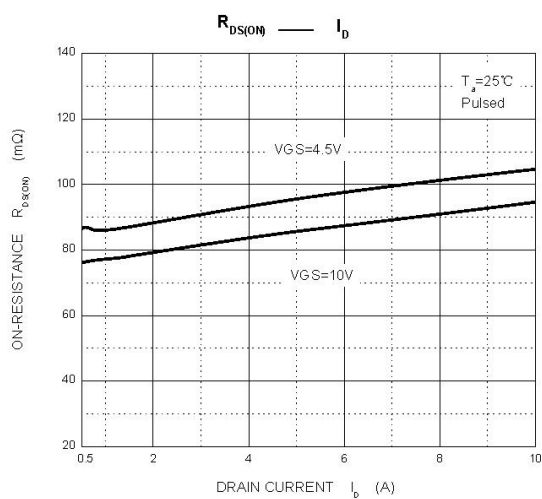
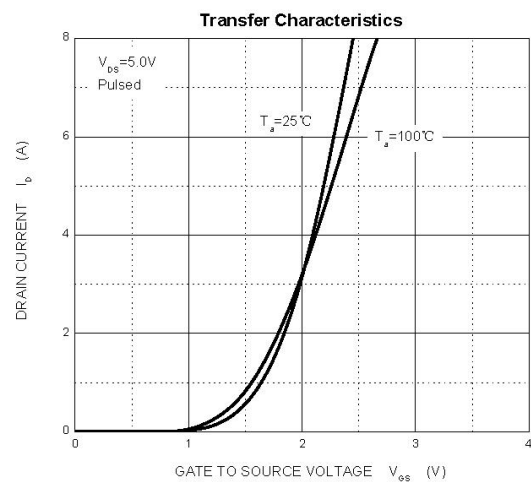
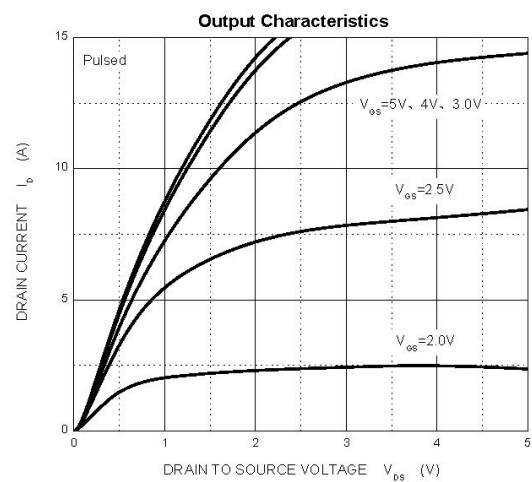

SOT-23 PACKAGE OUTLINE DIMENSIONS

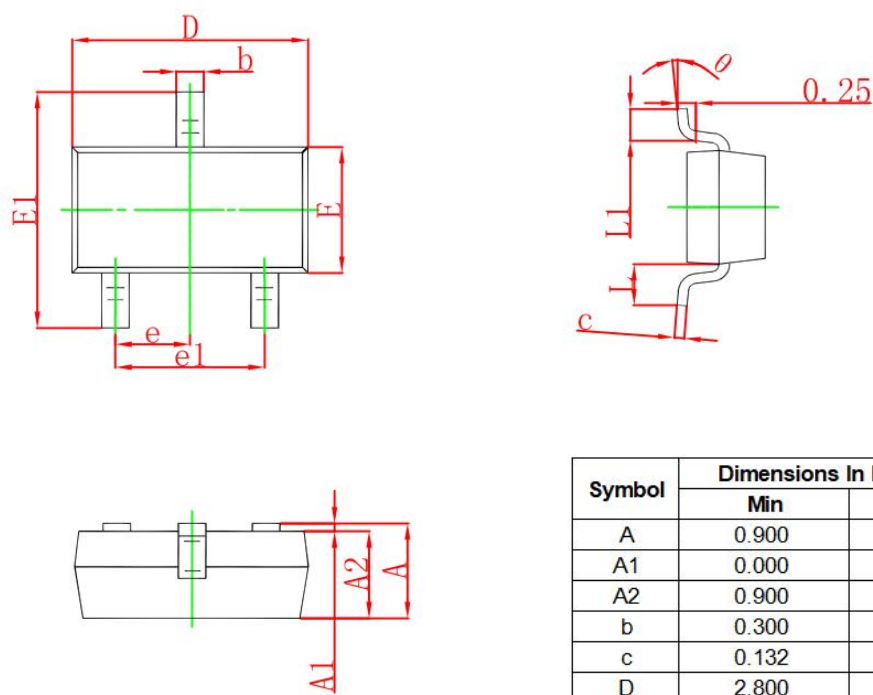

Symbol	Dimensions In Millimeters		Dimensions In Inches	
	Min	Max	Min	Max
A	0.900	1.150	0.035	0.045
A1	0.000	0.100	0.000	0.004
A2	0.900	1.050	0.035	0.041
b	0.300	0.500	0.012	0.020
c	0.132	0.202	0.005	0.008
D	2.800	3.000	0.110	0.118
E	1.200	1.400	0.047	0.055
E1	2.250	2.550	0.089	0.100
e1	1.800	2.000	0.071	0.079
L	0.55REF		0.022 REF	
L1	0.300	0.500	0.012	0.020
θ	0°	8°	0°	8°

SOT-23 SUGGESTED PAD LAYOUT

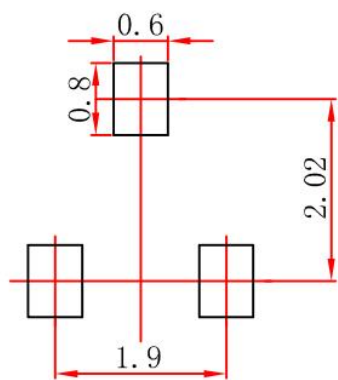

- Note:
- 1. Controlling dimension in millimeters.
 - 2. General tolerance: ±0.05mm.
 - 3. The pad layout is for reference purpose only.

SOT-23 TAPE AND REEL

SOT-23 Embossed Carrier Tape

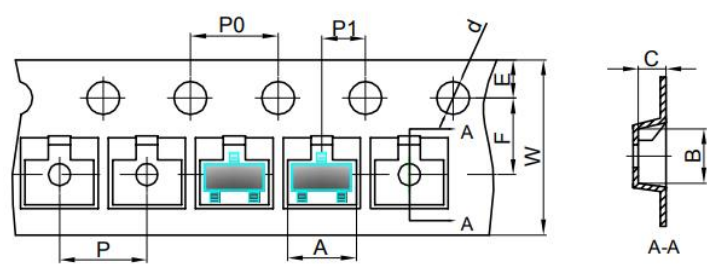

Packaging Description:
SOT-23 parts are shipped in tape. The carrier tape is made from a dissipative (carbon filled) polycarbonate resin. The cover tape is a multilayer film (Heat Activated Adhesive in nature) primarily composed of polyester film, adhesive layer, sealant, and anti-static sprayed agent. These reeled parts in standard option are shipped with 3,000 units per 7" or 17.8cm diameter reel. The reels are clear in color and is made of polystyrene plastic (anti-static coated).

Dimensions are in millimeter										
Pkg type	A	B	C	d	E	F	P0	P	P1	W
SOT-23	3.15	2.77	1.22	Ø1.50	1.75	3.50	4.00	4.00	2.00	8.00

SOT-23 Tape Leader and Trailer

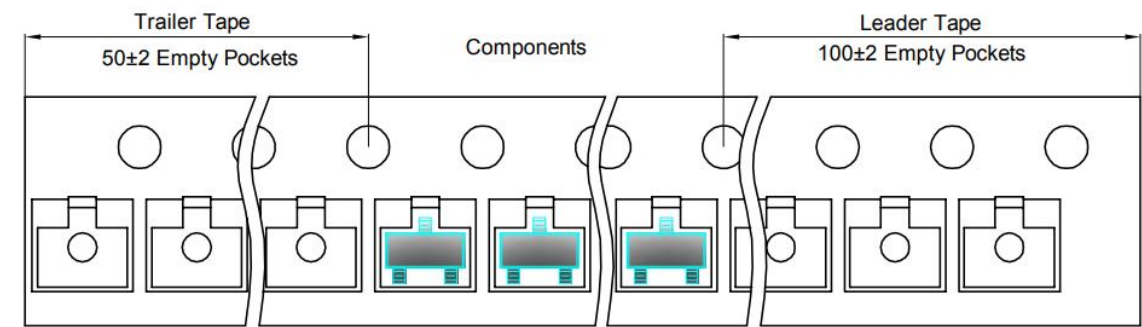

SOT-23 Reel

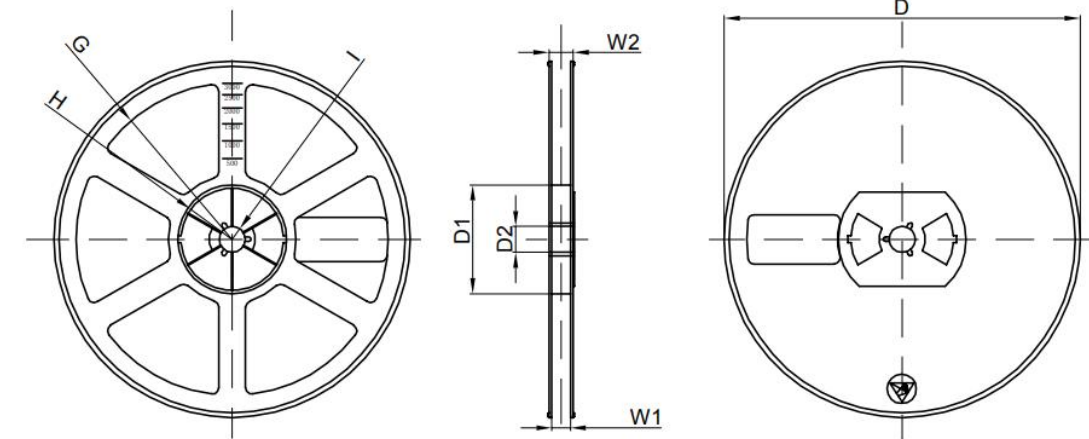

Dimensions are in millimeter								
Reel Option	D	D1	D2	G	H	I	W1	W2
7"Dia	Ø178.00	54.40	13.00	R78.00	R25.60	R6.50	9.50	12.30

REEL	Reel Size	Box	Box Size(mm)	Carton	Carton Size(mm)	G.W.(kg)
3000 pcs	7 inch	30,000 pcs	203×203×195	120,000 pcs	438×438×220	

PUBLISHED BY**JIANGSU CHANGJING ELECTRONICS TECHNOLOGY CO., LTD.****13th Floor, C Block, Tengfei Building, Yan Chuang Yuan, Nanjing Jiangbei New Area, China****LEGAL DISCLAIMER**

The information given in this document shall in no event be regarded as a guarantee of conditions or characteristics. With respect to any examples, hints or typical values stated herein and/or any information regarding the application of the device, JSCJ hereby disclaims any and all warranties and liabilities of any kind, including without limitation, warranties of non-infringement of intellectual property rights of any third party.

In addition, any information given in this document is subject to customer's compliance with its obligations stated in this document and any applicable legal requirements, norms and standards concerning customer's products and any use of the product of JSCJ in customer's applications.

The data contained in this document is exclusively intended for technically trained staff. It is the responsibility of customer's technical departments to evaluate the suitability of the product for the intended application and the completeness of the product information given in this document with respect to such application.

INFORMATION

For further information on technology, delivery terms and conditions as well as prices, please contact your nearest JSCJ office (www.jscj-elec.com).

WARNINGS

Due to technical requirements, products may contain dangerous substances. For information on the types in question, please contact your nearest JSCJ office.

Except as otherwise explicitly approved by JSCJ in a written document signed by authorized representatives of JSCJ, JSCJ's products may not be used in any applications where a failure of the product or any consequences of the use thereof can reasonably be expected to result in personal injury.